

REV.	DESCRIPTION	DATE	DRAFTER	APPROVER
A1	DWG.REL	2020.5.20	ZHANG	JIN

- Material  
 @Housing : PA66, UL94V-0  
 @Pin header : Copper alloy, Tin plated  
 @Mnt : M2.5, Copper alloy

- Electrical UL IEC  
 Rated voltage : 300V 320V  
 Rated current : 15A 20A  
 Contact resistance : 20mΩ(Max)  
 Insulation resistance: 500MΩ/DC500V  
 Withstanding Voltage : AC2000V/1min

- Mechanical  
 Operating temperature: -40°C ~ +105°C  
 Soldering temperature: 250°C ±5/5sec

• RoHS compliance

HOW TO ORDER  
 KF1024-5.08-XXP-1 X-XXXXX

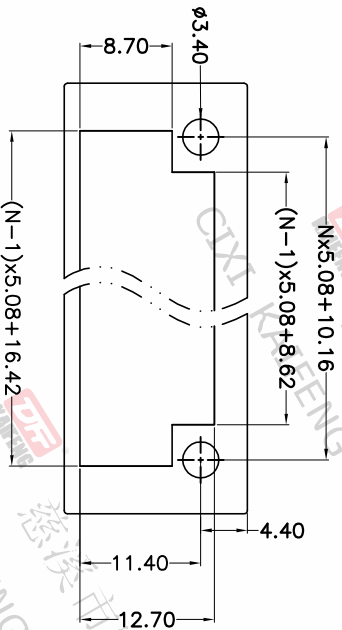
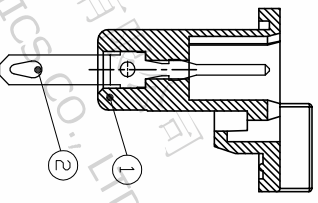
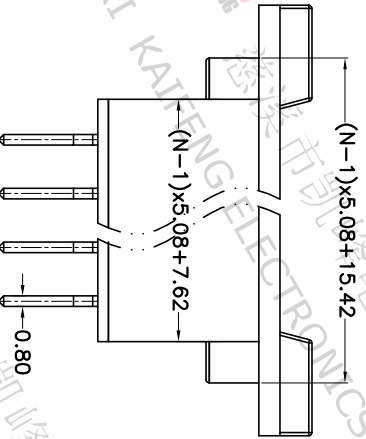
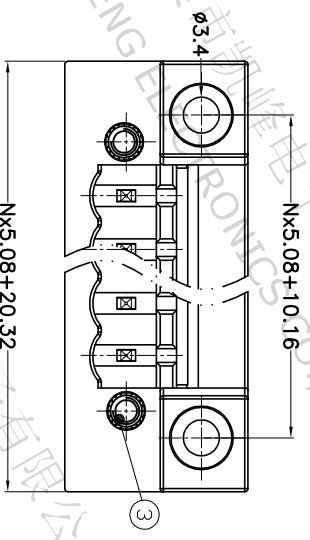
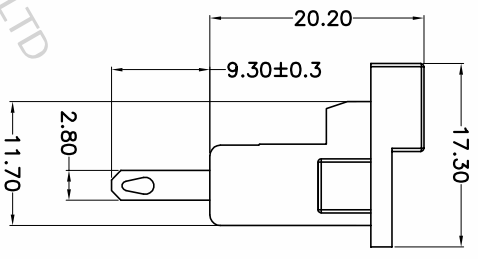
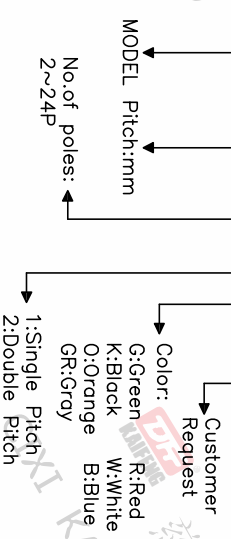

Pitch range	Nominal dimension range	PROJECTION
>0	>6	0.1/10
~	~	~
6	10	~
~	~	~
10	24	~
~	~	~
±0.15	±0.20	±2°
±0.30	±0.30	
±0.50	±0.50	
±0.70	±1.00	
±1.30	±1.30	

DRAWING TYPE	CUSTOMER DRAWING
SCALE	1:1
SHEET	1 OF 1
DRAWING NO.	W10001652

PROJECTION	UNIT	TITLE
mm	A4	KF1024-5.08-XXP-1X
SHEET SIZE	SERIES	
A4	KF1024	

**DF** 慈溪市凯峰电子有限公司  
 CIXI KAIFENG ELECTRONICS CO.,LTD